



TSS-UNI UNIVERSAL TURN SIGNAL SYSTEM

Thank you for purchasing XTC Power Products Turn Signal System. Our new Easy Install Turn Signal System is unique from the other kits on the market. This kit is completely plug and play, no wires to cut with only power, ground and install the four LED turn lights.

For more details on installation along with model installation go to www.xtcinstall.com
Please read the instructions fully and familiarize yourself with the components before starting the install.

1. **Mount the Control Unit** under the dash or other suitable place using the supplied screws.

WARNING! Verify that there is clearance before drilling the holes for the LED's and keep the harness away from any hot or moving parts.

2. **Install the two front LED lights** - Drill $\frac{3}{4}$ " holes in the front corners, remove the rubber grommets from the LED's and insert into the holes, insert the LED's into the grommets with the mark TOP on top.



3. **Run the short front harness** from the front LED lights to the control box and plug into mating connector. The Green wire harness go to the right/passenger side and the yellow wire harness go to the left/drivers side. Both green and yellow wires are positive and go to the black wire on each side, the white wire goes to white. Secure the harness with the provided cable ties. **NOTE: Black wire is positive and the White is ground, they will not work if reversed.**
4. **Install the rear lights**- Decide where to mount the two RED LED lights, if purchased kit came with round $\frac{3}{4}$ " lights, drill the $\frac{3}{4}$ " holes, remove the rubber grommets from the lights and insert into the holes, then insert the LED's into the grommets with the mark TOP on top. If purchased with optional 4" thin red LED's lights, find a suitable place to mount them, they can be mounted with the 3M double sticky tape or with screws.
5. **Run the Rear Harness** - Start at the right rear of the car and attach the Green and White wires to the right rear LED, the Green gets attached to the black wire and the white to the white wire. Do the same for the left, the Yellow wire gets attached to the black wire and the white wire goes to the white wire. Run the rest of the harness with the four pin connector up to the control box and plug into the mating connector, make sure to keep the harness away from any hot or moving parts, secure with provided cable ties. **NOTE: Black wire is positive and the White is ground, they will not work if reversed.**
6. **Using the rear lights as brake lights, this step is optional** - The orange wire coming out on the rear harness is used to activate the rear lights as brake lights for more visibility. To use verify that your car uses positive voltage through the

brake switch using a test light. Using the provided wire tap, tap the orange wire into the output side of the positive switch or to a brake light positive wire. **Sample installs can be seen at www.xtcinstall.com**

WARNING! Verify that there is clearance behind dash for Turn, Hazard and Horn switch's

7. **Install the Turn Switch** - Using the switch housing as a template, mark the rectangle for the switch and drill a hole in each corner, using a sharp box knife cut out the rectangle. Install the switch mount into the cutout, run the switch connector through and attach the turn switch and insert into housing.

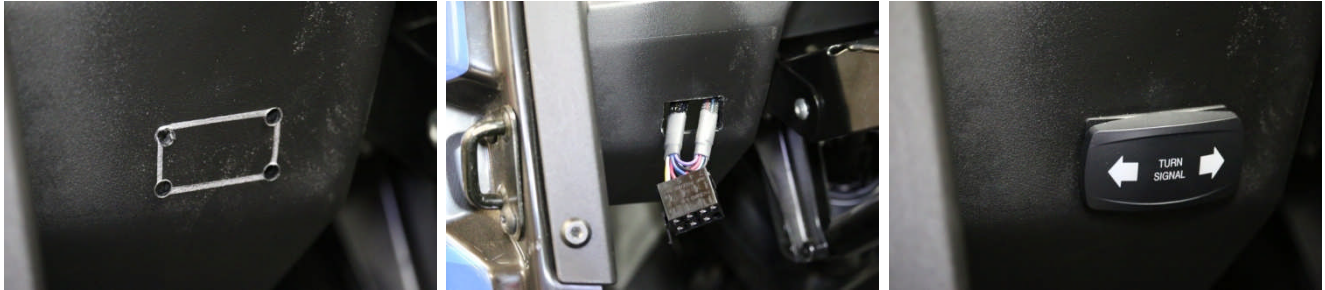

8. **Install Hazard and Horn Switch** - Drill a 3/4" hole for the hazard switch, make a notch in the hole for the index. Push hazard wires through to the switch, **Black wire to top bronze, Blue wire middle, and brown wire bottom**. Mark and drill a 13/16" hole in the dash to mount the horn button and attach the red and violet wires to it and insert into hole.



9. **Mount the Horn** -Pick a suitable place to mount the horn using the included hardware. Attach the purple wire from the front harness to the horn and attach the black ground wire to the other and run to chassis ground.
10. Run the red power wire to 12vdc battery and black wire to ground on the battery. If battery or power posts are not available, use the included T-Taps. Find 12vdc like the accessory power out and crimp the taps into the positive and negative wires, cut off the ring terminals, strip wire and crimp male slip connectors on. Insert the red wire with new connector into the previously installed taps, make sure the red goes to positive and the black goes to the negative.
11. Verify operation of all lights and secure the harness's with the provided cable ties.

For more details on installation go to www.xtcinstall.com

We can also be reached by email at support@xtcpowerproducts.com

XTC Power Products
A Division of XTC Motorsports LLC
925 N McQueen RD. #101
Gilbert AZ 85233
480-558-8588

www.xtcpowerproducts.com

*Disclaimer: This kit is intended for off road use only and XTC Motorsports claims no responsibility for its use. It is up to the purchaser to make sure it complies with all Federal, State and Local laws.